

RF 180° 2-Way



A₁



H₁



T12-3



T15-1

Power Splitters/Combiners Plug-In & Coaxial

2Way												
Model No.	Freq. Range (MHz) fL-fU	Insertion Loss (dB)			Isolation (dB)			(VSWR)		Unbalance		Case Style
		L	M	U	L	M	U	Max		Phase (°)	Amp (dB)	
		Typ/Ma	Typ/Ma	Typ/Ma	Typ/Min	Typ/Min	Typ/Min	In	Out	Max	Max	
CMICMIFYA-2-1	1-200	0.75/1.0	0.5/0.8	0.75/1.2	30/25	30/25	30/20			4	0.3	A1
CMICMIFYA-2-1W	10-600	1.0/1.5	1.1/1.6	1.2/2.2	30/25	25/20	20/16			6	0.9	A1
CMICMIFYA-2-2	0.1-50	1.0/1.5	1.0/1.5	1.0/1.5	30/25	30/25	25/20			3	0.5	A1
CMICMIFYA-2-4	50-1000	1.2/1.9		1.6/2.4	30/20		25/20			7	1.0	A1
*CMICMIFYA-2-1Z	5-200	0.8/1.0	0.9/1.1	1.0/1.5	22/20	24/20	24/18			8	0.5	A1
CMICMIFYH-2-1	1-200	0.75/1.0	0.5/0.8	0.75/1.2	30/25	30/25	30/25			4	0.3	H1
CMICMIFYH-2-1W	5-400	1.0/1.5	0.75/1.0	1.0/1.5	30/25	30/25	30/25			4	0.4	H1
CMIFYT-2-1	1-200	0.75/1.0	0.5/0.8	0.75/1.2	30/25	30/25	30/20			4	0.3	T12-3
CMIFYT-2-1W	10-600	1.0/1.5	1.1/1.6	1.2/2.2	30/25	25/20	20/16			6	0.9	T12-3
CMIFYT-2-2	0.1-50	0.5/1.0	0.5/1.0	0.5/1.0	30/25	30/25	25/20			3	0.5	T12-3
CMIFYT-2-4	50-1000	1.2/1.9		1.6/2.4	30/20		25/20			7	1.0	T12-3
CMIFYT-2-0515	50-1500	1.0/1.2	1.5	2.0	14	14	14			4	1.0	T12-3
CMIFYT-2-1020	1000-2000		1.5/2.0			22/18				6	0.8	T15-1
CMIFYT-2-1030	1000-3000		1.5/2.5			22/18				6	1.0	T15-1

CALL OUR SALES DEPARTMENT FOR MORE INFORMATION OR VARIATIONS OF THIS PRODUCT.

**Corry Micronics, Inc. One Plastics Rd. - Corry, PA 16407
(814) 664-7728 Fax (814) 664-4582 www.cormic.com**

Corry Micronics Inc. herein referred to CMI, believes this information to be accurate, but makes no warranties, expressed or implied as to the accuracy of this document. CMI assumes no liability for any injury, loss, damage, direct or consequential arising from the use of our products. User assumes all risk whatsoever in connection with it's intended use. CMI also reserves the right to change this document without notice.

Pin Connections:

Model No.	Sum Port	Port 1	Port 2	Subtractive Port	Gnd Ext.
CMIFYA-2-X	1	5	6		2,3,4,7,8
*CMIFYA-2-1Z	1	2	3	4	5,6,7,8
CMIFYH-2-X	8	4	5		2,3,5,6,7

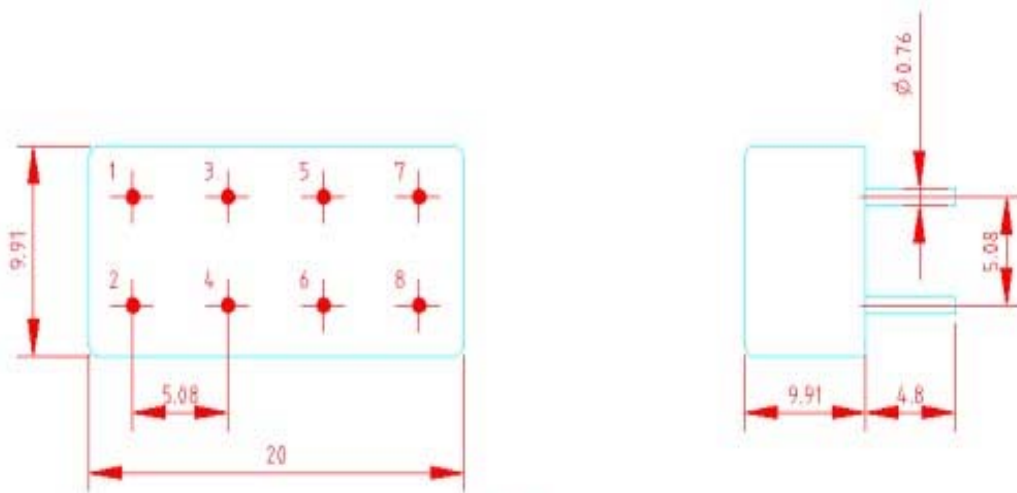

A1

CALL OUR SALES DEPARTMENT FOR MORE INFORMATION OR VARIATIONS OF THIS PRODUCT.

**Corry Micronics, Inc. One Plastics Rd. - Corry, PA 16407
(814) 664-7728 Fax (814) 664-4582 www.cormic.com**

Corry Micronics Inc. herein referred to CMI, believes this information to be accurate, but makes no warranties, expressed or implied as to the accuracy of this document. CMI assumes no liability for any injury, loss, damage, direct or consequential arising from the use of our products. User assumes all risk whatsoever in connection with it's intended use. CMI also reserves the right to change this document without notice.

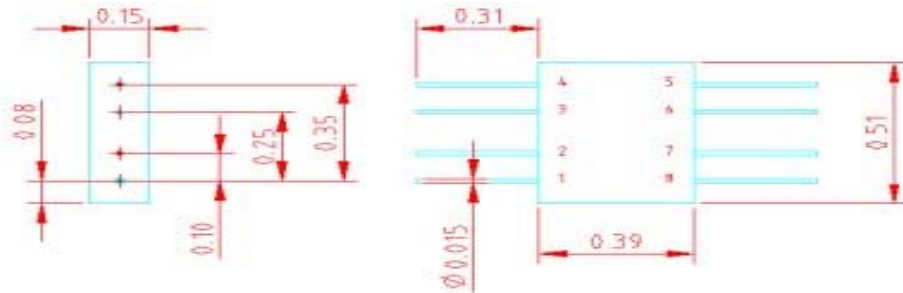

H1

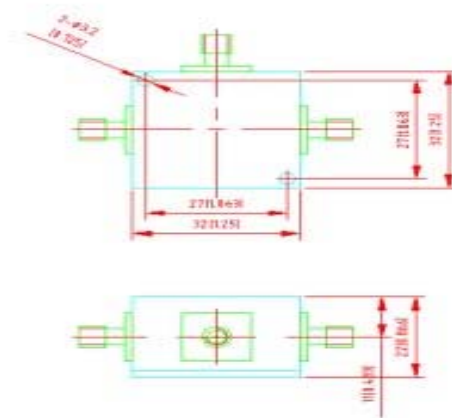

T12-3

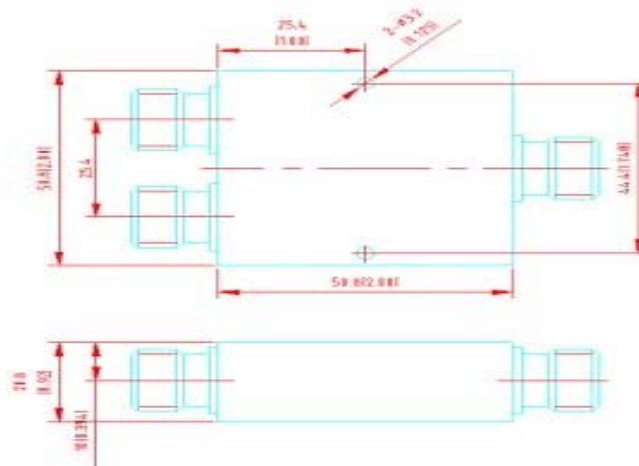

T15-1

CALL OUR SALES DEPARTMENT FOR MORE INFORMATION OR VARIATIONS OF THIS PRODUCT.

**Corry Micronics, Inc. One Plastics Rd. - Corry, PA 16407
(814) 664-7728 Fax (814) 664-4582 www.cormic.com**

Corry Micronics Inc. herein referred to CMI, believes this information to be accurate, but makes no warranties, expressed or implied as to the accuracy of this document. CMI assumes no liability for any injury, loss, damage, direct or consequential arising from the use of our products. User assumes all risk whatsoever in connection with it's intended use. CMI also reserves the right to change this document without notice.